







# TIME TO TAKE IT EASY

## Relax. Everything's Under Control With Compool

You want your new investment to be a place of relaxation and fun, not another chore. With a Compool

Cp3810 aquatic control system, convenience is as easy as touching a button. You'll have more time to unwind with family and friends. And isn't that what it's all about?

### The hassle-free way to enjoy your pool or spa.

The Compool Cp3810 allows you to operate your pool or spa from a control center inside your home. Just press a button and you can control lights, fountains — even water temperature. And with the easy-to-use programming buttons, you also can set all these functions to operate automatically.

### Cp3810 remembers for you.

Compool's intelligent circuitry helps out every day — remembering the right way to operate your pumps and heater, while guarding against freeze damage.

**Maintenance made simple.** To simplify maintenance, a three-hour clean-up cycle lets your pool service override the system without ever entering your home. Then the Cp3810 automatically resets three hours later — putting all regular programming back on schedule.



Control fountains

**An investment that really pays off.** You'll quickly discover that the modest investment in a Compool Cp3810 goes beyond convenience. Compool helps ensure safe operation and extended equipment life. And with the right pump scheduling, you can reduce your energy consumption and possibly take advantage of off-peak electrical rates.



*From the indoor control panel, all functions are at your command. Heating, lighting,*

*t automatic.*



**Lighting right on time**  
Easily program landscape or security lighting to keep your yard well-lit and safe. Optional dimming feature lets you adjust intensity.



*cleaning — Compool makes it*

*For convenient servicing, all equipment can be manually operated from outdoors.*



## Convenience And Control At Your Fingertips

Without ever going outside, you can operate all your equipment from the Compool Cp3810 control center. Just press a button to program your filtration, lighting, heating or cleaning cycles. There are no complicated sequences to memorize or menu selections to deal with.

Side doors close to conceal programming from children.

High / Low thermostats give you two temperature choices.

Easy-to-read display shows you system status at a glance.

Auxiliary buttons are custom labeled for easy identification.

Security button disables outdoor remote control.

Color-coded buttons for easy programming.



**Water features, fiber-optic lighting,** whatever your dreams may be, talk with your custom builder about how a Compool Cp3810 will make your dream a reality.



**Special water features**  
Whether your waterfall or fountain is operated by pump or motorized valve, Compool puts the control at your fingertips.



**Expand your system**  
For added convenience, you may install additional control panels — for example, in a guest house or master bedroom.



**Freeze protection**  
Temperature sensor guards against freeze damage by automatically running the pumps when temperatures plunge.



TIME TO TAKE IT EASY

## Customize Your Cp3810 Aquatic Control System

Whether you are building a custom pool or spa, the Compool Cp3810 aquatic control system can be tailored to suit your individual needs. With up to six auxiliary circuits at your fingertips, the Cp3810 will control automatic pool cleaners, fountains, waterfalls, Fiberworks® lighting, the revolutionary SA<sub>m</sub>® spectrum of colors pool light, and just about anything else you can dream of.

Expand your Compool system with the following options:



**Four button remote control** allows you to operate four functions from outdoors, for example: filtration, jets, heat boost and lights. Center indicator lights up when filter is on and flashes during heating.

**Eight button remote control** gives you up to eight functions, while displaying

time and water temperature on backlit LCD. Up/Down buttons provide temperature control at your patio, pool house, or water's edge.

**Telephone remote control** lets you turn your heater on from any touch tone phone so the water is warm when you arrive.



**Automatic backwash** for PurexTriton® sand filters provides maintenance-free filtration.

**Solar control** delivers maximum comfort from your solar energy collectors. Solar-priority feature automatically



switches from solar to back-up heater when solar is not available.

**Dimming circuits** allow you to dim lighting from either the indoor control panel or outdoor remote control. The system can accommodate two dimming circuits up to 1000 watts each.



With a Compool system you can say good-bye to all the cares of running your pool or spa. Compool gives you back the extra time and energy it takes to keep your investment just the way you like — convenient, comfortable and sparkling clean. Now you can really relax!



### Features

- Programmable filter pump and 6 auxiliaries
- Up to four on/off programs per circuit
- Countdown timer on any circuit
- One-time use program
- Outdoor remote lockout button
- Recirculating freeze protection
- Heater cool-down cycle
- Pool cleaner/filter pump interlock
- Temperature display, Fahrenheit or Celsius
- High / Low thermostats accurate to 1°F
- Use with gas, electric or heat pump
- Heat boost from outdoor remote control
- Override buttons at equipment pad
- Three-hour filter pump override

# purex triton

Pool and Spa Systems



Compool, Inc.  
599 Fairchild Drive  
Mountain View, CA 94043  
Phone (650) 964-2201 Fax (650) 964-5429  
<http://www.compool.com>

PacFab, Inc. Headquarters  
1620 Hawkins Ave.  
Sanford, NC 27330  
Phone (919) 774-4151 Fax (919) 774-4841  
Customer Service Fax (800) 284-4151  
<http://www.pacfabinc.com>

PacFab, Inc. West  
10957 West Los Angeles Ave.  
Moorpark, CA 93021  
Phone (805) 523-2400 Fax (800) 831-3129  
Customer Service Fax (800) 284-4151

KEEP DOOR CLOSED TO PREVENT WATER DAMAGE

**Compool**  
**EQUIPMENT CONTROL PANEL**





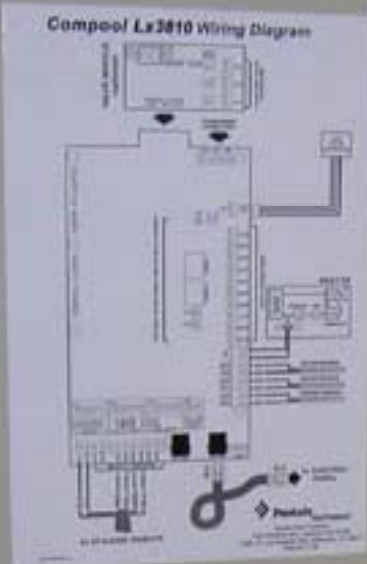

MODEL T4800W1175  
 120V 60Hz 1000VA  
 1000VA

**POWER ASSET**  
 CHECK THE POWER SOURCE BEFORE USE  
 THE POWER SOURCE MUST BE 120V 60Hz

### Compoof Lx2810

Power Source for Compoof Lx2810

**Installation Instructions**

**1. Check the Power Source**

Check the power source before use. The power source must be 120V 60Hz. If the power source is not 120V 60Hz, the device will not work.

**2. Check the Connections**

Check the connections between the power source and the device. The connections must be correct. If the connections are not correct, the device will not work.

**3. Check the Grounding**

Check the grounding of the device. The device must be grounded. If the device is not grounded, it may be damaged.

**4. Check the Safety**

Check the safety of the device. The device must be used safely. Do not touch the device when it is powered on.

**WARNING**

DO NOT TOUCH THE DEVICE WHEN IT IS POWERED ON. THE DEVICE MAY BE DAMAGED OR YOU MAY BE INJURED.

Part No.	Part Name	Quantity
1	Power Source	1
2	Control Unit	1
3	Relay	1
4	Sensor	1
5	Wiring	1

Power Source

Control Unit

Relay

Sensor

DO NOT TOUCH THE DEVICE WHEN IT IS POWERED ON. THE DEVICE MAY BE DAMAGED OR YOU MAY BE INJURED.