

10" Anti-Entrapment Suction Outlet Cover, Riser Ring and Mud Frame

VGB Series

Product Specification Sheet

The AquaStar line of suction outlet covers, compliant with the new Virginia Graeme-Baker Pool and Spa Safety Act (ASME/ANSI A112.19.8b-2009)

Features

For single or multiple drain use
(see installation instructions)

Requires a minimum 3" sump depth

Single

Floor: 166 GPM at 4.8 fps

Wall: 96 GPM at 2.8 fps

Floor/wall: 53 GPM at 1.5 fps

11.2 square inch opening

#316 stainless steel screws

Manufactured from superior
UV-resistant engineered polymers

Meets or exceeds NSF 50/ASME/ANSI
A112.19.8b-2009 national standards
and ASTM G154 UV testing

Listed with IAPMO R&T

8 per case



Part # 10AVRxxx

Also fits: 10" Waterway and Color Match

Part Numbers / Colors

- 10AVR101 White
- 10AVR102 Black
- 10AVR103 Lt. Gray
- 10AVR104 Blue
- 10AVR105 Dk. Gray
- 10AVR106 Bone
- 10AVR107 Taupe
- 10AVR108 Tan

VGB 2008 Compliant

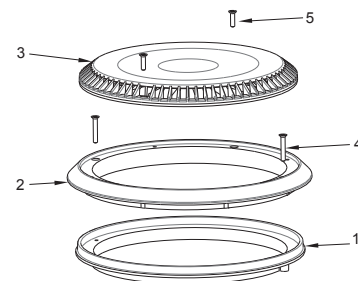
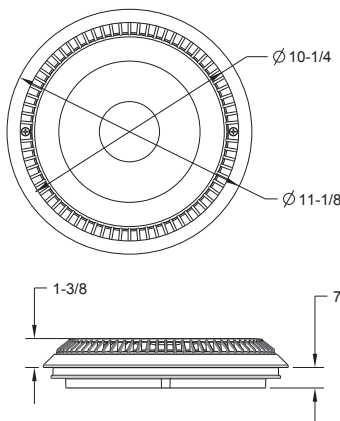

1. 10" round frame
2. Riser ring for 10" cover
3. 10" anti-entrapment suction outlet cover
4. #10 x 1-1/4" flat-head phillips type A screw, 316 ss, qty 2
5. #10 x 3/4" flat-head phillips type A screw, 316 ss, qty 2

ADDITIONAL PRODUCT CONFIGURATIONS FOR 10AVRxxx

Features: Sump Buckets for 10AVRxxx

For single or multiple drain use (see installation instructions)

#316 stainless steel screws

Manufactured from superior UV-resistant engineered polymers

Meets or exceeds NSF 50/ASME/ANSI A112.19.8a-2008 national standards and ASTM G154 UV testing

Sold with 10AVRxxx, not sold separately

10" Anti-Entrapment Suction Outlet with 10" Double-Deep Sump



Part #
10AVRDDxxx
4 per case

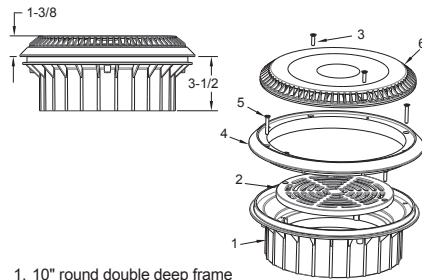

- 10" round double deep frame
- 8" flat grate (optional)
- #10 x 3/4" flat-head phillips type A screw, 316 ss, qty 4
- Riser ring for 10" cover
- #10 x 1-1/4" flat-head phillips type A screw, 316 ss, qty 2
- 10" anti-entrapment suction outlet cover

10" Anti-Entrapment Suction Outlet Cover with Dual-Port 2 1/2" Spigot x 2" Socket Deep PVC Sump



Part #
10AVRDDSBxxx
4 per case

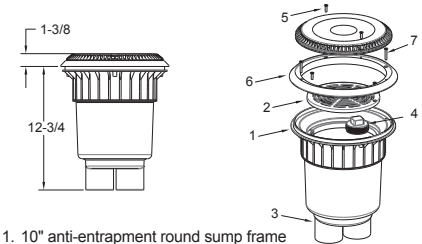

- 10" anti-entrapment round sump frame
- 8" flat grate (optional)
- Dual-port 2-1/2" spigot x 2" socket deep PVC sump
- 2" tapered pipe thread plug
- #10 x 3/4" flat-head phillips type A screw, 316 ss, qty 4
- Riser ring for 10" cover
- #10 x 1 1/4" flat-head phillips type A screw, 316 ss, qty 2
- 10" anti-entrapment suction outlet cover

10" Anti-Entrapment Suction Outlet Cover with 4" Spigot Deep PVC Sump



Part #
10AVRDDSB4SPxxx
4 per case

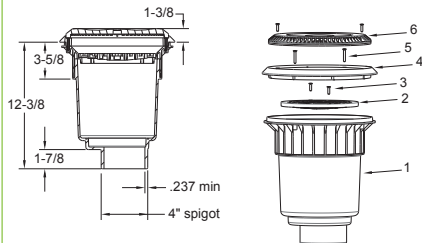

- 4" spigot deep PVC sump
- 8" flat grate (optional)
- #10 x 3/4" flat-head phillips type A screw, 316 ss, qty 4
- Riser ring for 10" cover
- #10 x 1-1/4" flat-head phillips type A screw, 316 ss, qty 2
- 10" anti-entrapment suction outlet cover

10" Anti-Entrapment Suction Outlet Cover with 4" Socket Deep PVC Sump



Part #
10AVRDDSB4SOCxxx
4 per case

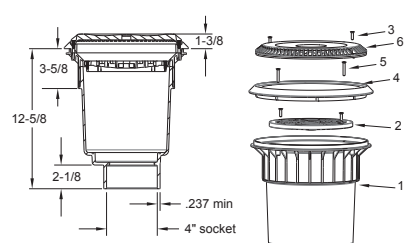

- 4" socket deep pvc sump
- 8" flat grate (optional)
- #10 x 3/4" flat-head phillips type A screw, 316 ss, qty 4
- Riser ring for 10" cover
- #10 x 1 1/4" flat-head phillips type A screw, 316 ss, qty 2
- 10" anti-entrapment suction outlet cover

10" Anti-Entrapment Suction Outlet Cover with 4" Socket Deep PVC Sump



Part #
10AVRDDSB6SPxxx
4 per case

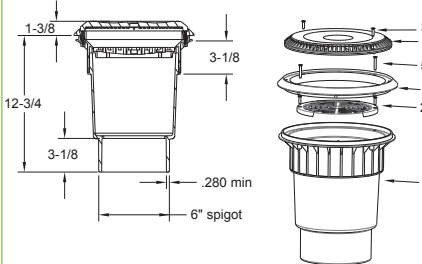

- 6" spigot deep PVC sump
- 8" flat grate (optional)
- #10 x 3/4" flat-head phillips type A screw, 316 ss, qty 4
- Riser ring for 10" cover
- #10 x 1-1/4" flat-head phillips type A screw, 316 ss, qty 2
- 10" anti-entrapment suction outlet cover

10" Anti-Entrapment Suction Outlet Cover with 6" Spigot Deep PVC Sump



Part #
10AVRDDSB6SOCxxx
4 per case

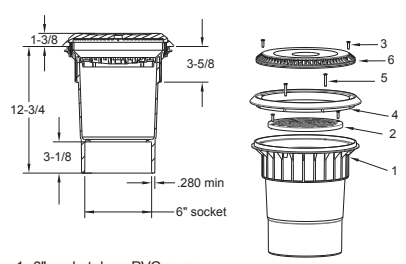

- 6" socket deep PVC sump
- 8" flat grate (optional)
- #10 x 3/4" flat-head phillips type A screw, 316 ss, qty 2
- Riser ring for 10" cover
- #10 x 1 1/4" flat-head phillips type A screw, 316 ss, qty 2
- 10" anti-entrapment suction outlet cover