



Pool Pumps - In-Ground / SVL56 - High Flow - 56-Frame

FEATURES:

- Extremely quiet operation
- High efficiency with maximum flow
- Self-priming
- Best vertical lift at 24 ft.
- Easy to service
- True 56-frame motor for cooler running and longer life
- 2 1/2" union threads x 2" FPT with unions (included)
- Large trap basket with cam-lock lid
- 60 Hz rating



For replacement parts, see page 183.
For unions, see page 156.

The extraordinary quietness of the SVL56 moves us nearer to the goal of silent operation, and it provides by far the best vertical lift. A true 56-frame motor ensures long life and uninterrupted power. Attention to detail is evident in the design of this proven pump. Designed for easy serviceability and installation, the pump accepts either 2" or 2 1/2" plumbing connections and features dual bearings for cooler operating temperature. This pump will provide years of trouble-free performance.

ENERGY EFFICIENT PRESSURE VERSUS FLOW RATE

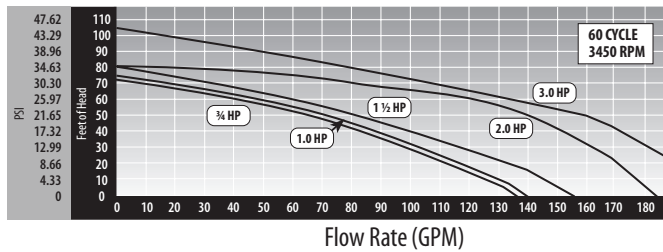

STANDARD EFFICIENCY PRESSURE VERSUS FLOW RATE

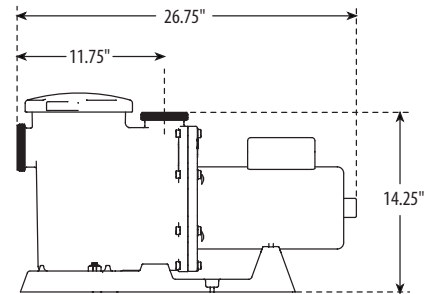
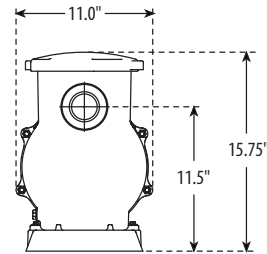
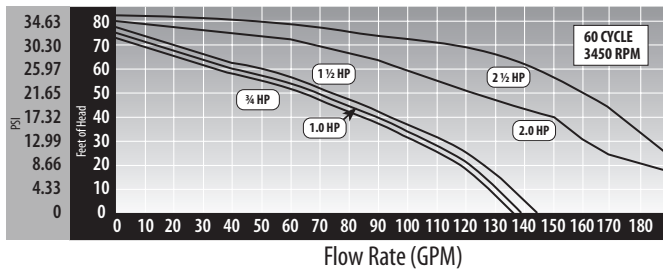

Energy Efficient - Full Rated

| Part No. | Description | Volts | HP | Weight (lbs.) | List (US \$) |
|------------|---|---------|-----|---------------|--------------|
| SVL56E-110 | 1-Speed - 2" or 2 1/2" Intake and Discharge | 115/230 | 1.0 | 40 | 1102.30 |
| SVL56E-115 | 1-Speed - 2" or 2 1/2" Intake and Discharge | 230 | 1.5 | 44 | 1192.42 |
| SVL56E-120 | 1-Speed - 2" or 2 1/2" Intake and Discharge | 230 | 2.0 | 48 | 1326.23 |
| SVL56E-130 | 1-Speed - 2" or 2 1/2" Intake and Discharge | 230 | 3.0 | 52 | 1699.00 |

Standard Efficiency - Maximum Rated

| Part No. | Description | Volts | HP | Weight (lbs.) | List (US \$) |
|------------|---|---------|-----|---------------|--------------|
| SVL56S-107 | 1-Speed - 2" or 2 1/2" Intake and Discharge | 115/230 | 3/4 | 38 | 875.62 |
| SVL56S-110 | 1-Speed - 2" or 2 1/2" Intake and Discharge | 115/230 | 1.0 | 40 | 919.32 |
| SVL56S-115 | 1-Speed - 2" or 2 1/2" Intake and Discharge | 115/230 | 1.5 | 44 | 971.20 |
| SVL56S-120 | 1-Speed - 2" or 2 1/2" Intake and Discharge | 230 | 2.0 | 46 | 1107.76 |
| SVL56S-125 | 1-Speed - 2" or 2 1/2" Intake and Discharge | 230 | 2.5 | 48 | 1307.11 |
| SVL56S-215 | 2-Speed - 2" or 2 1/2" Intake and Discharge | 230 | 1.5 | 45 | 1189.69 |
| SVL56S-220 | 2-Speed - 2" or 2 1/2" Intake and Discharge | 230 | 2.0 | 47 | 1234.76 |
| SVL56S-225 | 2-Speed - 2" or 2 1/2" Intake and Discharge | 230 | 2.5 | 48 | 1420.44 |



FEATURES:

- Quiet operation
- High efficiency
- Self-priming
- 2" FPT intake and discharge
- 2" unions included
- Easy to service
- True 56-frame motor for cooler running and longer life
- Large trap basket with cam-lock lid
- 60 Hz rating



For replacement parts, see page 185.
For unions, see page 156.

**FULL RATED - 1-SPEED
PRESSURE VERSUS FLOW RATE**

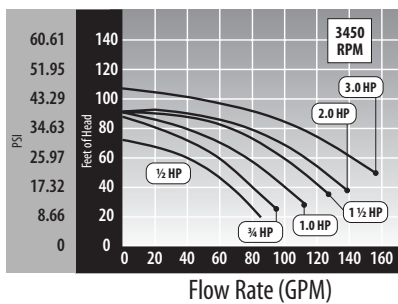

**2-SPEED
PRESSURE VERSUS FLOW RATE**

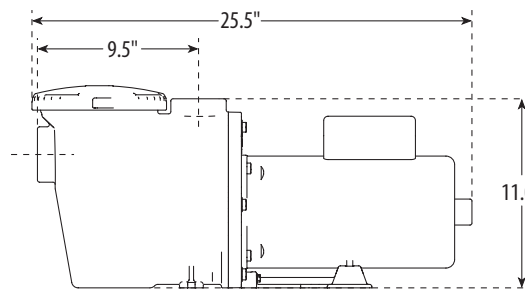
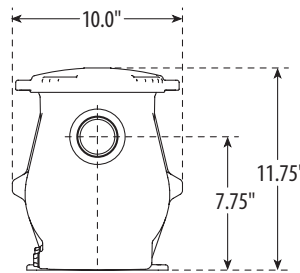
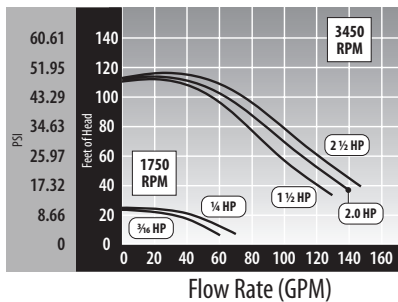

The Champion High Performance Pump is compatible with all cleaning systems, various filters and jet action spas. The Champion Pump is ideal for new installations and as a replacement pump due to its dimensions.

Energy Efficient - Full Rated

| Part No. | Description | Volts | HP | List (US \$) |
|-------------------|-------------|---------|-----|--------------|
| CHAMPE-107 | 1-Speed | 115/230 | 3/4 | 958.40 |
| CHAMPE-110 | 1-Speed | 115/230 | 1.0 | 1032.84 |
| CHAMPE-115 | 1-Speed | 115/230 | 1.5 | 1132.11 |
| CHAMPE-120 | 1-Speed | 230 | 2.0 | 1273.84 |
| CHAMPS-130 | 1-Speed | 230 | 3.0 | 1530.88 |

Standard Efficiency - Maximum Rated

| Part No. | Description | Volts | HP | List (US \$) |
|-------------------|-------------|---------|-----|--------------|
| CHAMPS-107 | 1-Speed | 115/230 | 3/4 | 840.85 |
| CHAMPS-110 | 1-Speed | 115/230 | 1.0 | 883.95 |
| CHAMPS-115 | 1-Speed | 115/230 | 1.5 | 932.94 |
| CHAMPS-120 | 1-Speed | 230 | 2.0 | 1034.16 |
| CHAMPS-125 | 1-Speed | 230 | 2.5 | 1249.65 |
| CHAMPS-130 | 1-Speed | 230 | 3.0 | 1530.88 |
| CHAMPS-215 | 2-Speed | 230 | 1.5 | 1198.90 |
| CHAMPS-220 | 2-Speed | 230 | 2.0 | 1192.86 |
| CHAMPS-225 | 2-Speed | 230 | 2.5 | 1363.29 |



Pool Pumps - Above Ground / Supreme - 48-Frame

FEATURES:

- 1 1/2" Union threads / 1 1/2" FPT Intake and 2" Union threads / 1 1/2" FPT discharge
- Extra large 7" pump trap with clear lid
- Powerful side discharge performance
- Wet end easily rotates



For replacement parts, see page 187.

The Supreme Pump is the ultimate in above ground pool engineering. Designed for today's more demanding applications, the Supreme Pump is ideal for D.E., cartridge or sand filtration systems of all sizes.

PRESSURE VERSUS FLOW RATE

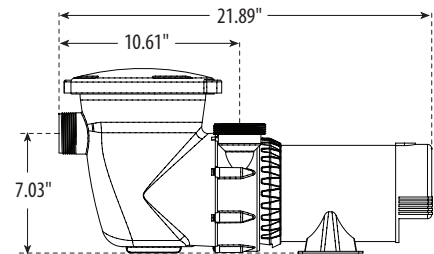
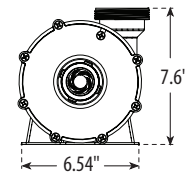
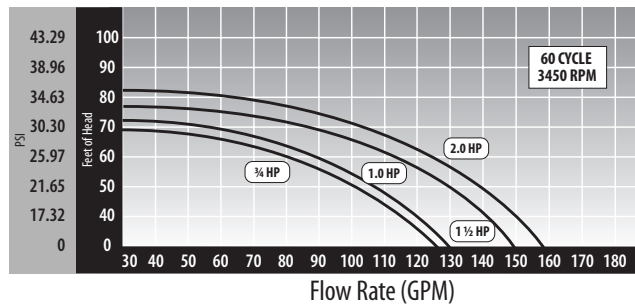

Supreme 48-Frame Above Ground Pool Pump

| Part No. | Description | Volts | Amps | HP | Weight (lbs.) | List (US \$) |
|-----------|---------------------------------|-------|-------|-----|---------------|--------------|
| PSP1075-3 | 1-Speed - 3 ft. Twist-Lock Cord | 115 | 10.78 | 3/4 | 27 | 514.37 |
| PSP1100-3 | 1-Speed - 3 ft. Twist-Lock Cord | 115 | 13.2 | 1.0 | 28 | 523.84 |
| PSP1150-3 | 1-Speed - 3 ft. Twist-Lock Cord | 115 | 13.2 | 1.5 | 33.5 | 563.45 |
| PSP1200-3 | 1-Speed - 3 ft. Twist-Lock Cord | 115 | 18.04 | 2.0 | 35 | 663.87 |
| PSP2075-3 | 2-Speed - 3 ft. Twist-Lock Cord | 115 | 10.78 | 3/4 | 27 | 613.67 |
| PSP2100-3 | 2-Speed - 3 ft. Twist-Lock Cord | 115 | 13.2 | 1.0 | 29 | 627.18 |
| PSP2150-3 | 2-Speed - 3 ft. Twist-Lock Cord | 115 | 13.2 | 1.5 | 33.5 | 673.52 |
| PSP2200-3 | 2-Speed - 3 ft. Twist-Lock Cord | 115 | 18.04 | 2.0 | 35 | 721.81 |
| PSP1075-6 | 1-Speed - 6 ft. NEMA Cord | 115 | 10.78 | 3/4 | 29 | 514.37 |
| PSP1100-6 | 1-Speed - 6 ft. NEMA Cord | 115 | 13.2 | 1.0 | 33 | 523.84 |
| PSP1150-6 | 1-Speed - 6 ft. NEMA Cord | 115 | 13.2 | 1.5 | 36 | 563.45 |
| PSP1200-6 | 1-Speed - 6 ft. NEMA Cord | 115 | 18.04 | 2.0 | 38 | 663.87 |
| PSP2075-6 | 2-Speed - 6 ft. NEMA Cord | 115 | 10.78 | 3/4 | 29 | 613.67 |
| PSP2100-6 | 2-Speed - 6 ft. NEMA Cord | 115 | 13.2 | 1.0 | 33 | 627.18 |
| PSP2150-6 | 2-Speed - 6 ft. NEMA Cord | 115 | 13.2 | 1.5 | 36 | 673.52 |
| PSP2200-6 | 2-Speed - 6 ft. NEMA Cord | 115 | 18.04 | 2.0 | 38 | 721.81 |

Part numbers listed are for the discharge in the vertical position (sand). For discharge in horizontal position (cartridge and D.E.), add "R" to the end of the part number.

1-speed pumps have an on/off toggle switch. 2-speed pumps have a hi/lo/off toggle switch included.

NEMA cord is 3 prong grounded.



FEATURES:

- 1 1/2" union threads / 1 1/2" FPT intake and 2" union threads / 1 1/2" FPT discharge
- Powerful side discharge performance
- Wet end can be rotated for easy installation
- Large 6" pump trap with one-piece clear lid
- High head capability
- Trap is 2" union x 1 1/2" union / 1 1/2" FPT



For replacement parts, see page 189.

PRESSURE VERSUS FLOW RATE

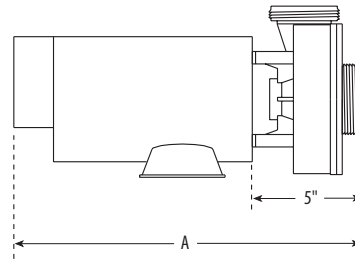
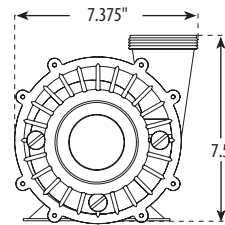
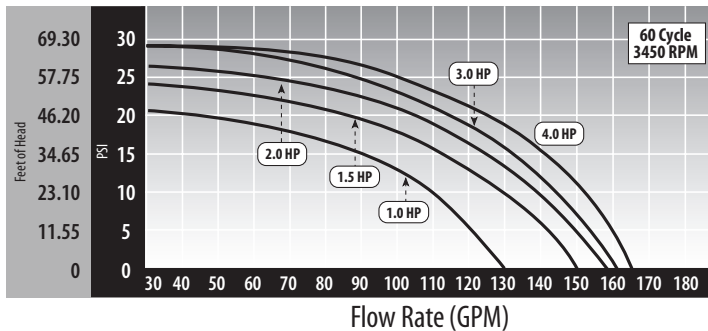

The Hi-Flo Above Ground pump was designed for superior and efficient performance. The Hi-Flo pump features high flow rate performance for faster filtering cycles. This pump is ideal for new installations or as a replacement pump.

Hi-Flo Side Discharge 48-Frame Above Ground Pool Pump and Trap

| Part No. | Description | Volts | HP | Weight (lbs.) | List (US \$) |
|------------------|---------------------------------|-------|-----|---------------|--------------|
| PH1075-3 | 1-Speed - 3 ft. Twist-Lock Cord | 115 | 3/4 | 24 | 468.90 |
| PH1100-3S | 1-Speed - 3 ft. Twist-Lock Cord | 115 | 1.0 | 25 | 484.75 |
| PH1150-3 | 1-Speed - 3 ft. Twist-Lock Cord | 115 | 1.5 | 30.5 | 523.38 |
| PH1200-3 | 1-Speed - 3 ft. Twist-Lock Cord | 115 | 2.0 | 32 | 623.82 |
| PH2075-3 | 2-Speed - 3 ft. Twist-Lock Cord | 115 | 3/4 | 24 | 573.62 |
| PH2100-3 | 2-Speed - 3 ft. Twist-Lock Cord | 115 | 1.0 | 25 | 587.13 |
| PH2150-3 | 2-Speed - 3 ft. Twist-Lock Cord | 115 | 1.5 | 30.5 | 633.46 |
| PH2200-3 | 2-Speed - 3 ft. Twist-Lock Cord | 115 | 2.0 | 32 | 681.76 |
| PH1075-6 | 1-Speed - 6 ft. NEMA Cord | 115 | 3/4 | 26 | 475.10 |
| PH1100-6S | 1-Speed - 6 ft. NEMA Cord | 115 | 1.0 | 30 | 498.80 |
| PH1150-6S | 1-Speed - 6 ft. NEMA Cord | 115 | 1.5 | 33 | 523.38 |
| PH1200-6 | 1-Speed - 6 ft. NEMA Cord | 115 | 2.0 | 35 | 623.82 |
| PH2075-6 | 2-Speed - 6 ft. NEMA Cord | 115 | 3/4 | 26 | 573.62 |
| PH2100-6S | 2-Speed - 6 ft. NEMA Cord | 115 | 1.0 | 30 | 591.66 |
| PH2150-6S | 2-Speed - 6 ft. NEMA Cord | 115 | 1.5 | 33 | 633.46 |
| PH2200-6S | 2-Speed - 6 ft. NEMA Cord | 115 | 2.0 | 35 | 681.76 |

Part numbers listed are for the discharge in the vertical position (sand). For discharge in horizontal position (cartridge and D.E.), add "R" to the part number.

1-speed pumps have an on/off toggle switch. 2-speed pumps have a hi/lo/off toggle switch included.

NEMA cord is 3 prong grounded.



Pool Pumps - Above Ground / Center Discharge - 48-Frame

FEATURES:

- 1 1/2" Union / 1 1/2" FPT Inlet and Vertical Discharge or 1 1/2" Union / 1 1/2" FPT Inlet and Jacuzzi Self-Aligning Union Discharge (SLR9)
- Powerful center discharge performance
- Wet end can be rotated for easy installation
- Large 6" pump trap with one-piece clear lid
- High head capability
- Trap is 2" union x 1 1/2" union / 1 1/2" FPT



For replacement parts, see page 191.

PRESSURE VERSUS FLOW RATE

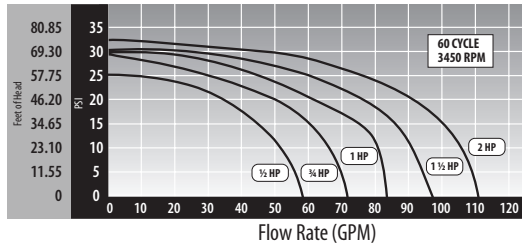

Center Discharge Above Ground Pool Pump

| Part No. | Description | HP | Volts | List (US \$) |
|---------------------|---------------------------------|-----|-------|--------------|
| 3410210-1544 | 1-Speed - 3 ft. Twist-Lock Cord | 1/2 | 115 | 457.02 |
| 3410413-1544 | 1-Speed - 3 ft. Twist-Lock Cord | 1.0 | 115 | 469.12 |
| 3410612-1544 | 1-Speed - 3 ft. Twist-Lock Cord | 1.5 | 115 | 507.65 |
| 3410811-1544 | 1-Speed - 3 ft. Twist-Lock Cord | 2.0 | 115 | 600.49 |
| 3420310-1544 | 2-Speed - 3 ft. Twist-Lock Cord | 3/4 | 115 | 553.50 |
| 3420411-1544 | 2-Speed - 3 ft. Twist-Lock Cord | 1.0 | 115 | 568.69 |
| 3420612-1544 | 2-Speed - 3 ft. Twist-Lock Cord | 1.5 | 115 | 611.72 |
| 3410210-1549 | 1-Speed - 6 ft. NEMA Cord | 1/2 | 115 | 457.02 |
| 3410314-1549 | 1-Speed - 6 ft. NEMA Cord | 3/4 | 115 | 459.82 |
| 3410413-1549 | 1-Speed - 6 ft. NEMA Cord | 1.0 | 115 | 469.12 |
| 3410612-1549 | 1-Speed - 6 ft. NEMA Cord | 1.5 | 115 | 507.65 |
| 3410811-1549 | 1-Speed - 6 ft. NEMA Cord | 2.0 | 115 | 604.12 |
| 3420310-1549 | 2-Speed - 6 ft. NEMA Cord | 3/4 | 115 | 553.50 |
| 3420411-1549 | 2-Speed - 6 ft. NEMA Cord | 1.0 | 115 | 568.69 |
| 3420612-1549 | 2-Speed - 6 ft. NEMA Cord | 1.5 | 115 | 611.72 |
| 3420610-1549 | 2-Speed - 6 ft. NEMA Cord | 2.0 | 115 | 654.75 |

Center Discharge Above Ground Pool Pump - Jacuzzi Style Threads

| Part No. | Description | HP | Volts | List (US \$) |
|---------------------|---------------------------------|-----|-------|--------------|
| 3410210-1524 | 1-Speed - 3 ft. Twist-Lock Cord | 1/2 | 115 | 469.30 |
| 3410314-1524 | 1-Speed - 3 ft. Twist-Lock Cord | 3/4 | 115 | 473.16 |
| 3410413-1524 | 1-Speed - 3 ft. Twist-Lock Cord | 1.0 | 115 | 482.84 |
| 3410612-1524 | 1-Speed - 3 ft. Twist-Lock Cord | 1.5 | 115 | 521.45 |
| 3410811-1524 | 1-Speed - 3 ft. Twist-Lock Cord | 2.0 | 115 | 618.63 |
| 3420310-1524 | 2-Speed - 3 ft. Twist-Lock Cord | 3/4 | 115 | 569.72 |
| 3420411-1524 | 2-Speed - 3 ft. Twist-Lock Cord | 1.0 | 115 | 585.19 |
| 3420612-1524 | 2-Speed - 3 ft. Twist-Lock Cord | 1.5 | 115 | 629.61 |
| 3410210-1529 | 1-Speed - 6 ft. NEMA Cord | 1/2 | 115 | 469.30 |
| 3410314-1529 | 1-Speed - 6 ft. NEMA Cord | 3/4 | 115 | 473.16 |
| 3410413-1529 | 1-Speed - 6 ft. NEMA Cord | 1.0 | 115 | 482.84 |
| 3410612-1529 | 1-Speed - 6 ft. NEMA Cord | 1.5 | 115 | 521.45 |
| 3410811-1529 | 1-Speed - 6 ft. NEMA Cord | 2.0 | 115 | 621.89 |
| 3420310-1529 | 2-Speed - 6 ft. NEMA Cord | 3/4 | 115 | 569.72 |
| 3420411-1529 | 2-Speed - 6 ft. NEMA Cord | 1.0 | 115 | 585.19 |
| 3420612-1529 | 2-Speed - 6 ft. NEMA Cord | 1.5 | 115 | 629.61 |



310-3500



310-3000

SVL56 Wet Ends

| Part No. | Description | Case Quantity | List (US \$) |
|-----------------|-------------|---------------|--------------|
| 310-3500 | 1 HP - EF | 10 | 458.51 |
| 310-3510 | 1.5 HP - EF | 10 | 458.51 |
| 310-3520 | 2 HP - EF | 10 | 458.51 |
| 310-3530 | 3 HP - EF | 10 | 458.51 |
| 310-3540 | ¾ HP - SF | 10 | 458.51 |
| 310-3550 | 1 HP - SF | 10 | 458.51 |
| 310-3560 | 1.5 HP - SF | 10 | 458.51 |
| 310-3570 | 2 HP - SF | 10 | 458.51 |
| 310-3580 | 2.5 HP - SF | 10 | 458.51 |

Champion Wet Ends

| Part No. | Description | List (US \$) |
|--------------------|---------------------------|--------------|
| 310-3000 | ¾ HP SF | 424.90 |
| 310-3010 | 1 HP SF | 424.90 |
| 310-3010-SS | 1 HP SF - Stainless Steel | 453.84 |
| 310-3020 | 1.5 HP SF | 424.90 |
| 310-3030 | 2 HP SF | 424.90 |
| 310-3030-SS | 2 HP SF - Stainless Steel | 453.84 |
| 310-3040 | 2.5 HP SF | 424.90 |
| 310-3050 | 3 HP SF | 424.90 |
| 310-3050-SS | 3 HP SF - Stainless Steel | 453.84 |
| 310-3060 | ¾ HP EF | 424.90 |
| 310-3070 | 1 HP EF | 424.90 |
| 310-3080 | 1.5 HP EF | 424.90 |
| 310-3090 | 2 HP EF | 424.90 |
| 310-3100 | 3 HP EF | 424.90 |



310-5400

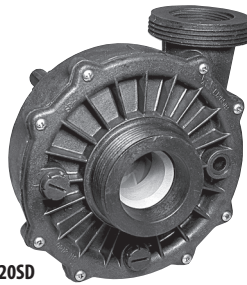

310-1120SD

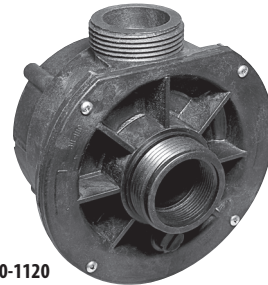

310-1120

6" Leaf Traps

| Part No. | Description | Case Quantity | List (US \$) |
|-----------------|-----------------|---------------|--------------|
| 310-5400 | 1 ½" x 1 ½" | 5 | 70.88 |
| 310-6500 | 1 ½" x 2" | 5 | 80.71 |
| 310-6600 | 2" x 2" | 5 | 80.71 |
| 310-6700 | 2" x 2" Workman | 5 | 111.49 |

Hi-Flo Wet Ends

| Part No. | Description | Case Quantity | List (US \$) |
|-------------------|-------------|---------------|--------------|
| 310-1120SD | ¾ HP | 15 | 100.34 |
| 310-1130SD | 1 HP | 15 | 100.34 |
| 310-1140SD | 1.5 HP | 15 | 100.34 |
| 310-1141SD | 2 HP | 15 | 100.34 |

Center Discharge Wet Ends

| Part No. | Description | Case Quantity | List (US \$) |
|-----------------|-------------|---------------|--------------|
| 310-1110 | ½ HP | 12 | 96.48 |
| 310-1120 | ¾ HP | 12 | 96.48 |
| 310-1130 | 1 HP | 12 | 96.48 |
| 310-1140 | 1.5 HP | 12 | 96.48 |
| 310-1141 | 2 HP | 12 | 96.48 |



Spa Pumps / Spa Flo - 48-Frame

FEATURES:

- 48-frame proven design
- Designed for direct replacement in most spas
- Viton seals
- 1 1/2" Intake and Discharge



PRESSURE VERSUS FLOW RATE

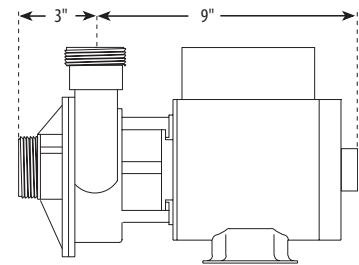
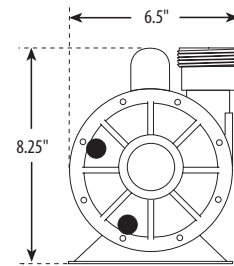
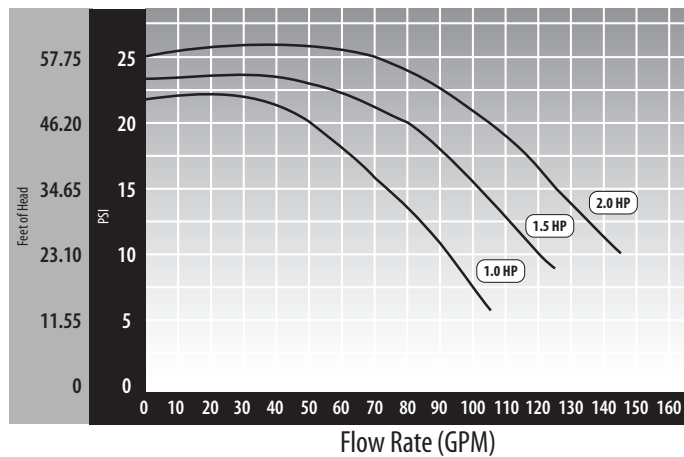

2-Speed Spa Flo 48-Frame Pumps

| Part No. | HP | Volts | Hz | Case Quantity | List (US \$) |
|-------------------|-------|-------|----|---------------|--------------|
| 3420410-0Z | 1 | 115 | 60 | 1 | 463.66 |
| 3420610-0Z | 1 1/2 | 115 | 60 | 1 | 549.26 |
| 3420820-0Z | 2 | 230 | 60 | 1 | 584.94 |

Sold without cords. Please call for available cords.

1-Speed Spa Flo 48-Frame Pumps

| Part No. | HP | Volts | Hz | Case Quantity | List (US \$) |
|-------------------|-------|-----------|----|---------------|--------------|
| 3410410-0Z | 1 | 115 | 60 | 1 | 584.94 |
| 3410610-0Z | 1 1/2 | 115 | 60 | -- | 599.20 |
| 3410830-0Z | 2 | 115 / 230 | 60 | 1 | 677.66 |

Sold without cords. Please call for available cords.



FEATURES:

- Super quiet operation
- 2" Unionized (Intake/Discharge)
- One piece pot and volute reduce noise
- Lower flow rates for more versatile installations

NEW

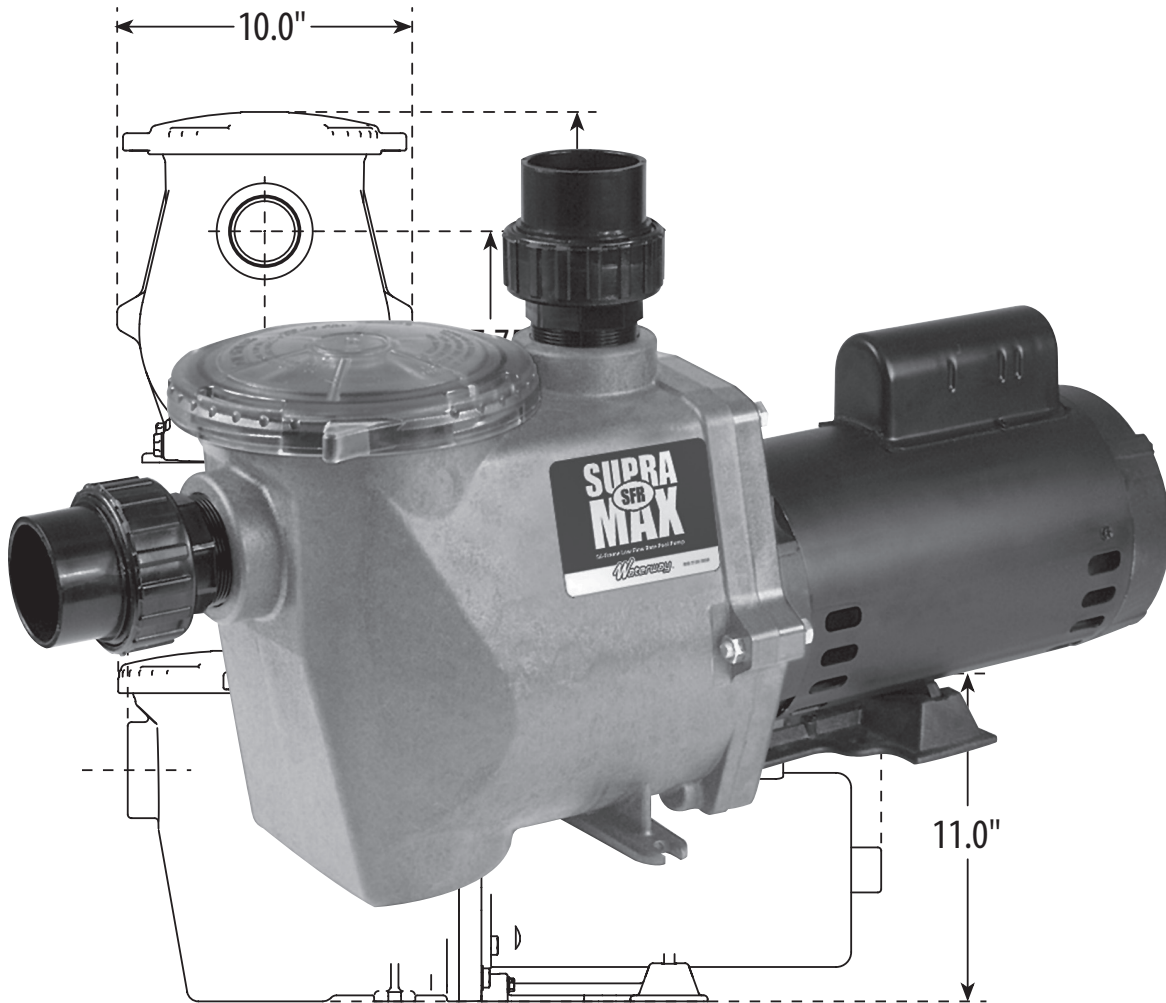

COMING SOON!



Spa Pumps / EX 2

FEATURES:

- True continuous rated horsepower of 1.5, 2.0, 2.5 and 3.0 HP
- 48-Frame or 56-Frame, Single or Dual Speed (energy saving)
- Use more jets per pump
- Same physical size as Aqua-Flo XP2, XP2e (fits within the same volume envelope)
- Can be used as substitute or retrofit to Aqua-Flo model XP2 or XP2e pumps and similar pumps and wet ends offered by other domestic and foreign suppliers
- Made in USA from highest quality materials with UL and CUL certifications
- CE and TUV certification on export pumps to ensure product performance for you and your customers
- Equipped with the highest quality Viton Seals
- Equipped with high efficiency electrical motors, custom designed for Spa applications



Call for available cords and plugs.

Call for Specifications

2-Speed EX 2 48-Frame Pumps

| Part No. | Description | HP | Volts | Amps High Speed | Amps Low Speed | Hz | List (US \$) |
|-------------------|--------------------------|-----|-------|-----------------|----------------|----|--------------|
| 3420410-1U | 2" Intake - 2" Discharge | 1 | 115 | 11.0 | 2.9 | 60 | 455.33 |
| 3420610-1U | 2" Intake - 2" Discharge | 1.5 | 115 | 16.4 | 4.4 | 60 | 497.21 |
| 3420620-1U | 2" Intake - 2" Discharge | 1.5 | 230 | 8.0 | 2.6 | 60 | 497.21 |
| 3420820-1U | 2" Intake - 2" Discharge | 2 | 230 | 10.5 | 2.6 | 60 | 526.81 |
| 3421221-1U | 2" Intake - 2" Discharge | 3 | 230 | 8.5 | 2.8 | 60 | 545.15 |
| 3421821-1U | 2" Intake - 2" Discharge | 4.5 | 230 | 12.0 | 3.5 | 60 | 614.58 |

1-Speed EX 2 48-Frame Pumps

| Part No. | Description | HP | Volts | Amps | Hz | List (US \$) |
|-------------------|--------------------------|-----|-----------|---------|----|--------------|
| 3410410-1U | 2" Intake - 2" Discharge | 1 | 115 | 12.0 | 60 | 393.96 |
| 3410610-1U | 2" Intake - 2" Discharge | 1.5 | 115 | 17.0 | 60 | 423.36 |
| 3410830-1U | 2" Intake - 2" Discharge | 2 | 115 / 230 | 20 / 10 | 60 | 484.81 |
| 3411621-1U | 2" Intake - 2" Discharge | 4 | 230 | 12 | 60 | 569.49 |

2-Speed EX 2 56-Frame Pumps

| Part No. | Description | HP | Volts | Amps High Speed | Amps Low Speed | Hz | List (US \$) |
|-------------------|--------------------------|----|-------|-----------------|----------------|----|--------------|
| 3720821-1U | 2" Intake - 2" Discharge | 2 | 230 | 8.0 | 3.0 | 60 | 529.60 |
| 3721221-1U | 2" Intake - 2" Discharge | 3 | 230 | 10.0 | 3.4 | 60 | 565.86 |
| 3721621-1U | 2" Intake - 2" Discharge | 4 | 230 | 12.0 | 4.4 | 60 | 616.90 |
| 3722021-1U | 2" Intake - 2" Discharge | 5 | 230 | 16.4 | 4.8 | 60 | 700.59 |

1-Speed EX 2 56-Frame Pumps

| Part No. | Description | HP | Volts | Amps | Hz | List (US \$) |
|-------------------|--------------------------|----|-------|------|----|--------------|
| 3710821-1U | 2" Intake - 2" Discharge | 2 | 230 | 8.0 | 60 | 529.60 |
| 3711221-1U | 2" Intake - 2" Discharge | 3 | 230 | 10.0 | 60 | 565.86 |
| 3711621-1U | 2" Intake - 2" Discharge | 4 | 230 | 12.0 | 60 | 587.02 |
| 3712021-1U | 2" Intake - 2" Discharge | 5 | 230 | 16.4 | 60 | 612.14 |



FEATURES:

- Viper wet end designed specifically for 56-frame motors
- Two double shielded ball bearings with moisture resistant grease for quieter operation and longer life
- Two speed motors have four sets of insulated windings for increased efficiency
- 56-frame motor for added strength, cooler operating temperature and longer motor life
- Large 2 ½" intake for improved flow performance and reduced noise
- Large 8" diameter wet end for increased volume capacity
- Split capacitor, (start and run) for less energy consumption
- Thermally protected to extend life expectancy of motor
- Highly versatile wet end can be rotated every 90°
- Viton seals
- Three year warranty on motor and wet end



Call for available cords and plugs.

PRESSURE VERSUS FLOW RATE

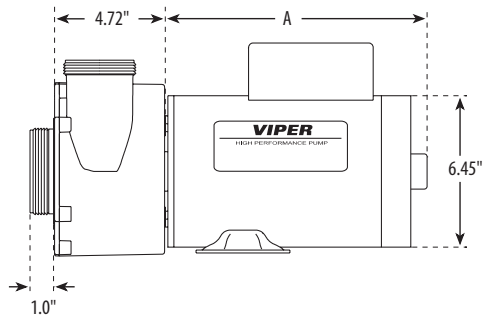
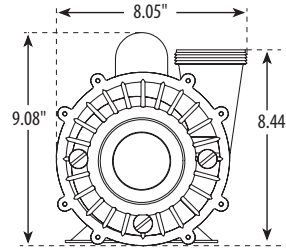
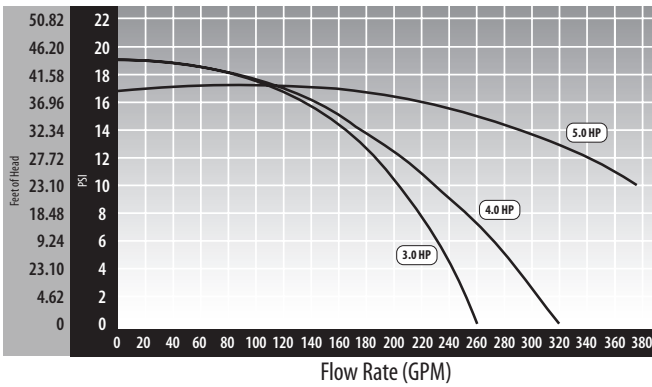

2-Speed Viper 56-Frame Pumps

| Part No. | Description | HP | Volts | Amps High Speed | Amps Low Speed | Hz | Dimension "A" | List (US \$) |
|-------------------|------------------------------|----|-------|-----------------|----------------|----|---------------|--------------|
| 3721221-1T | 2 ½" Intake - 2 ½" Discharge | 3 | 230 | 10 | 3.5 | 60 | 11" | 638.53 |
| 3721621-1T | 2 ½" Intake - 2 ½" Discharge | 4 | 230 | 12 | 4.4 | 60 | 11" | 685.51 |
| 3722021-0T | 2 ½" Intake - 2 ½" Discharge | 5 | 230 | 16.4 | 4.8 | 60 | 11" | 707.70 |

1-Speed Viper 56-Frame Pumps

| Part No. | Description | HP | Volts | Amps | Hz | Dimension "A" | List (US \$) |
|-------------------|------------------------------|----|-------|------|----|---------------|--------------|
| 3711621-0T | 2 ½" Intake - 2 ½" Discharge | 4 | 230 | 12 | 60 | 11" | 597.00 |
| 3712021-0T | 2 ½" Intake - 2 ½" Discharge | 5 | 230 | 16.4 | 60 | 11" | 639.83 |



Spa Pumps / Executive - 56-Frame

FEATURES:

- Executive wet end designed specifically for 56-frame motors
- Two double shielded ball bearings with moisture resistant grease for quieter operation and longer life
- Two speed motors have four sets of insulated windings for increased efficiency
- 56 frame motor for added strength, cooler operating temperature and longer motor life
- Large 2 1/2" intake for improved flow performance and reduced noise
- Large 6 1/2" diameter wet end for higher head pressure
- Split capacitor, (start and run) for less energy consumption
- Thermally protected to extend life expectancy of motor
- Highly versatile wet end can be rotated every 90°
- Viton seals
- Three year warranty on motor and wet end

Call for available cords and plugs.

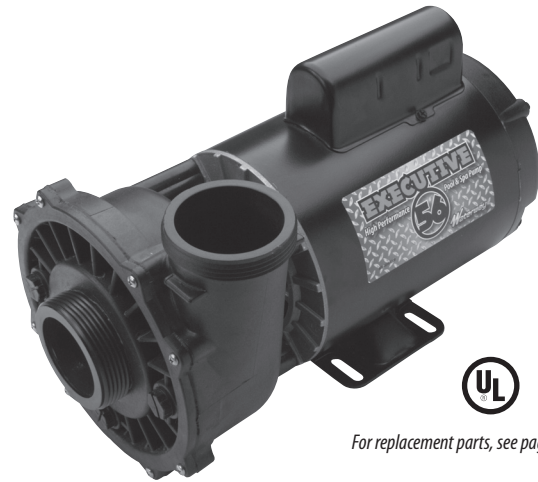

For replacement parts, see page 195.

PRESSURE VERSUS FLOW RATE

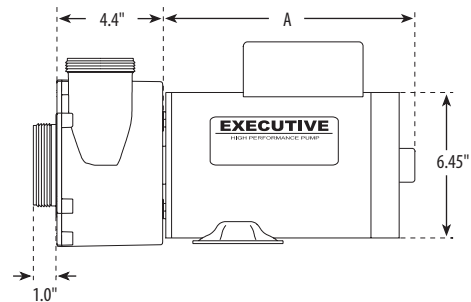
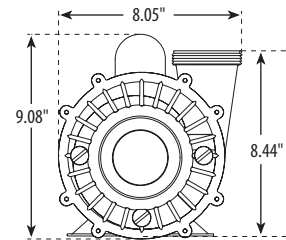
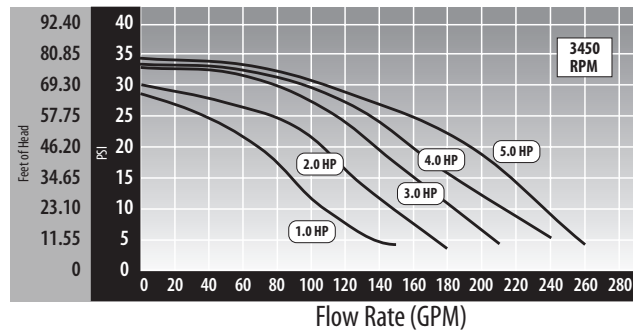

2-Speed Executive 56-Frame Pumps

| Part No. | Description | HP | Volts | Amps High Speed | Amps Low Speed | Hz | Dimension "A" | List (US \$) |
|-------------------|------------------------------|----|-------|-----------------|----------------|----|---------------|--------------|
| 3720821-1D | 2" Intake - 2" Discharge | 2 | 230 | 8.0 | 3.0 | 60 | 8.875" | 529.60 |
| 3720821-13 | 2 1/2" Intake - 2" Discharge | 2 | 230 | 8.0 | 3.0 | 60 | 8.875" | 529.60 |
| 3721221-1D | 2" Intake - 2" Discharge | 3 | 230 | 10.0 | 3.4 | 60 | 9.875" | 565.86 |
| 3721221-13 | 2 1/2" Intake - 2" Discharge | 3 | 230 | 10.0 | 3.4 | 60 | 9.875" | 565.86 |
| 3721621-1D | 2" Intake - 2" Discharge | 4 | 230 | 12.0 | 4.4 | 60 | 10.375" | 616.90 |
| 3721621-13 | 2 1/2" Intake - 2" Discharge | 4 | 230 | 12.0 | 4.4 | 60 | 10.375" | 616.90 |
| 3722021-1D | 2" Intake - 2" Discharge | 5 | 230 | 16.4 | 4.8 | 60 | 10.375" | 700.59 |
| 3722021-13 | 2 1/2" Intake - 2" Discharge | 5 | 230 | 16.4 | 4.8 | 60 | 10.375" | 700.59 |

1-Speed Executive 56-Frame Pumps

| Part No. | Description | HP | Volts | Amps | Hz | Dimension "A" | List (US \$) |
|-------------------|------------------------------|----|-------|------|----|---------------|--------------|
| 3710821-1D | 2" Intake - 2" Discharge | 2 | 230 | 8.0 | 60 | 8.875" | 529.60 |
| 3710821-13 | 2 1/2" Intake - 2" Discharge | 2 | 230 | 8.0 | 60 | 8.875" | 529.60 |
| 3711221-1D | 2" Intake - 2" Discharge | 3 | 230 | 10.0 | 60 | 9.875" | 565.86 |
| 3711221-13 | 2 1/2" Intake - 2" Discharge | 3 | 230 | 10.0 | 60 | 9.875" | 565.86 |
| 3711621-1D | 2" Intake - 2" Discharge | 4 | 230 | 12.0 | 60 | 10.375" | 587.02 |
| 3711621-13 | 2 1/2" Intake - 2" Discharge | 4 | 230 | 12.0 | 60 | 10.375" | 604.18 |
| 3712021-1D | 2" Intake - 2" Discharge | 5 | 230 | 16.4 | 60 | 10.375" | 604.18 |
| 3712021-13 | 2 1/2" Intake - 2" Discharge | 5 | 230 | 16.4 | 60 | 10.375" | 612.14 |



FEATURES:

- Executive wet end designed specifically for 48-frame motors
- Large 2 ½" intake for improved flow performance and reduced noise
- Large 6 ½" diameter wet end for higher head pressure
- Thermally protected to extend life expectancy of motor
- Highly versatile wet end can be rotated every 90°
- Viton seals
- 2-year warranty on motor, 3-year on wet end

Call for available cords and plugs.

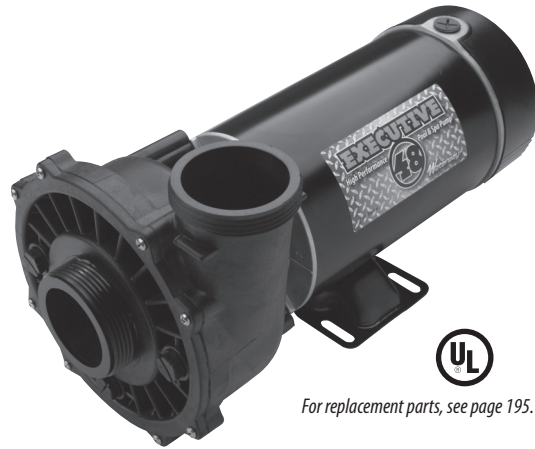

For replacement parts, see page 195.

PRESSURE VERSUS FLOW RATE

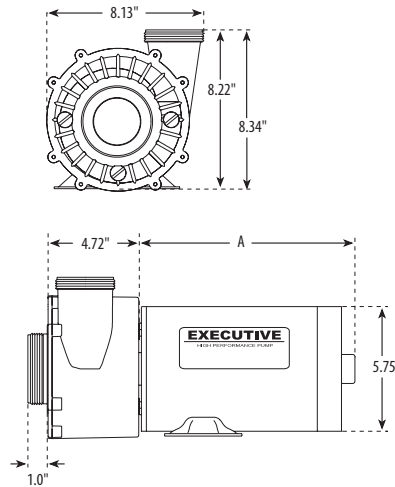
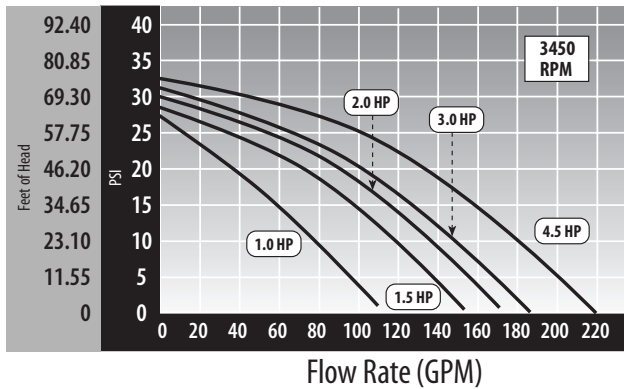

2-Speed Executive 48-Frame Pumps

| Part No. | Description | HP | Volts | Amps High Speed | Amps Low Speed | Hz | Dimension "A" | List (US \$) |
|-------------------|----------------------------|-----|-------|-----------------|----------------|----|---------------|--------------|
| 3420410-1A | 2" Intake - 2" Discharge | 1.0 | 115 | 11.0 | 2.9 | 60 | 9.73" | 455.33 |
| 3420410-13 | 2 ½" Intake - 2" Discharge | 1.0 | 115 | 11.0 | 2.9 | 60 | 9.73" | 455.33 |
| 3420610-1A | 2" Intake - 2" Discharge | 1.5 | 115 | 16.4 | 4.4 | 60 | 10.48" | 497.21 |
| 3420610-13 | 2 ½" Intake - 2" Discharge | 1.5 | 115 | 16.4 | 4.4 | 60 | 10.48" | 497.21 |
| 3420620-1A | 2" Intake - 2" Discharge | 1.5 | 230 | 8.0 | 2.6 | 60 | 10.45" | 497.21 |
| 3420620-13 | 2 ½" Intake - 2" Discharge | 1.5 | 230 | 8.0 | 2.6 | 60 | 10.45" | 497.21 |
| 3420820-1A | 2" Intake - 2" Discharge | 2.0 | 230 | 10.5 | 2.6 | 60 | 11.0" | 526.81 |
| 3420820-13 | 2 ½" Intake - 2" Discharge | 2.0 | 230 | 10.5 | 2.6 | 60 | 11.0" | 526.81 |
| 3421221-1A | 2" Intake - 2" Discharge | 3.0 | 230 | 8.5 | 2.8 | 60 | 11.0" | 545.15 |
| 3421221-13 | 2 ½" Intake - 2" Discharge | 3.0 | 230 | 8.5 | 2.8 | 60 | 11.0" | 545.15 |
| 3421821-1A | 2" Intake - 2" Discharge | 4.5 | 230 | 12.0 | 3.5 | 60 | 11.98" | 614.58 |
| 3421821-13 | 2 ½" Intake - 2" Discharge | 4.5 | 230 | 12.0 | 3.5 | 60 | 11.98" | 614.58 |

1-Speed Executive 48-Frame Pumps

| Part No. | Description | HP | Volts | Amps | Hz | Dimension "A" | List (US \$) |
|-------------------|----------------------------|-----|---------|-------|----|---------------|--------------|
| 3410410-1A | 2" Intake - 2" Discharge | 1.0 | 115 | 12 | 60 | 9.23" | 393.96 |
| 3410610-1A | 2" Intake - 2" Discharge | 1.5 | 115 | 17 | 60 | 9.78" | 423.36 |
| 3410830-1A | 2" Intake - 2" Discharge | 2.0 | 115/230 | 20/10 | 60 | 10.98" | 484.81 |
| 3410830-13 | 2 ½" Intake - 2" Discharge | 2.0 | 115/230 | 20/10 | 60 | 10.98" | 484.81 |
| 3411621-1A | 2" Intake - 2" Discharge | 4.0 | 230 | 12 | 60 | 11.18" | 569.49 |
| 3411621-13 | 2 ½" Intake - 2" Discharge | 4.0 | 230 | 12 | 60 | 11.18" | 569.49 |



Spa Pumps / Executive Euro - 50 Hz

WET END FEATURES:

- High performance Executive wet end specifically designed for 56-frame motors
- Large 2" intake for improved flow performance and noise reduction
- Large 6" diameter wet end for higher head pressure
- Highly versatile wet end can be rotated every 90°

MOTOR FEATURES:

- Water repellent Italian made EMG motor
- 56-frame motor for added strength, cooler operating temperature and longer motor life
- Two double shielded ball bearings with moisture resistant grease for quieter operation and longer life
- Two-speed motors have four sets of insulated windings for increased efficiency
- Split capacitor, (start and run) for less energy consumption
- Thermally protected to extend life expectancy of motor
- IPX5 construction



PUMP FEATURES:

- TUV listed
- TUV J and J mini plug (*optional*)
- Viton seals
- Three year warranty

PRESSURE VERSUS FLOW RATE

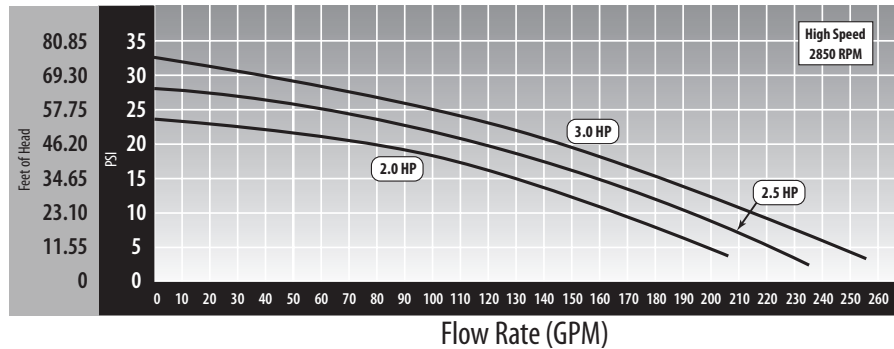

Executive Euro 50 Hz Pumps

| Part No. | Description | HP | Speed | Hz | Volts | Amps | List (US \$) |
|-------------------|---------------------|--------|---------|----|-------|-----------|--------------|
| 3R10850-0D | Executive Euro Pump | 2 HP | 1-Speed | 50 | 230 | 9.5 | 524.37 |
| 3R11250-0D | Executive Euro Pump | 3 HP | 1-Speed | 50 | 230 | 12.3/12.8 | 531.75 |
| 3R20850-0D | Executive Euro Pump | 2 HP | 2-Speed | 50 | 230 | 9.0/1.8 | 581.07 |
| 3R21050-0D | Executive Euro Pump | 2 ½ HP | 2-Speed | 50 | 230 | 11.4 | 607.03 |



FEATURES:

- High volume side discharge efficiency
- 60% more efficient than our center discharge pumps
- 2" intake and discharge
- Wet end can be rotated for easy installation
- Available in 1 to 4 HP, 1 or 2 speed
- Large 6 1/2" diameter wet end for higher head pressure
- Viton Seals
- One year warranty on motor, 3-year on wet end



For replacement parts, see page 189.

PRESSURE VERSUS FLOW RATE

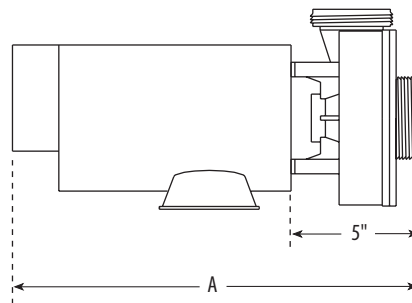
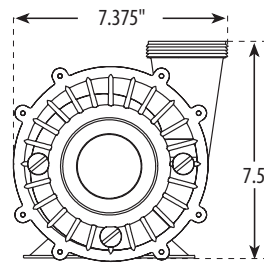
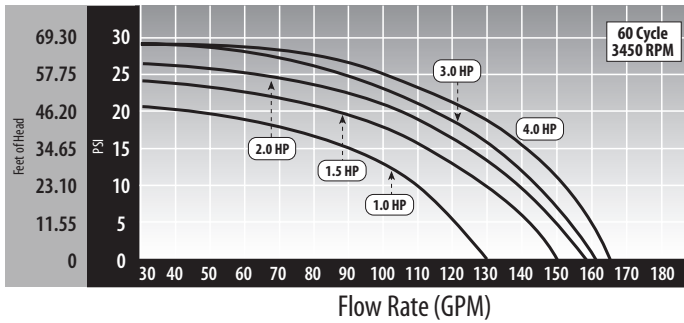

2-Speed Hi-Flo Side Discharge 48-Frame Pumps

| Part No. | HP | Volts | Amps High Speed | Amps Low Speed | Hz | Dimension "A" | List (US \$) |
|-------------------|-----|-------|-----------------|----------------|----|---------------|--------------|
| 3420410-10 | 1.0 | 115 | 11.0 | 2.9 | 60 | 14.73" | 455.33 |
| 3420610-10 | 1.5 | 115 | 16.4 | 4.4 | 60 | 15.48" | 497.21 |
| 3420620-10 | 1.5 | 230 | 8.0 | 2.6 | 60 | 15.48" | 497.21 |
| 3420820-10 | 2.0 | 230 | 10.5 | 2.6 | 60 | 16.00" | 526.81 |
| 3421221-10 | 3.0 | 230 | 8.5 | 2.8 | 60 | 16.00" | 545.15 |
| 3421621-10 | 4.0 | 230 | 12.0 | 3.5 | 60 | 16.98" | 614.58 |

1-Speed Hi-Flo Side Discharge 48-Frame Pumps

| Part No. | HP | Volts | Amps | Hz | Dimension "A" | List (US \$) |
|-------------------|-----|---------|-------|----|---------------|--------------|
| 3410410-10 | 1.0 | 115 | 12.0 | 60 | 14.23" | 393.96 |
| 3410612-10 | 1.5 | 115 | 17.0 | 60 | 14.78" | 393.96 |
| 3410830-10 | 2.0 | 115/230 | 20-10 | 60 | 14.98" | 484.81 |
| 3411621-10 | 4.0 | 230 | 12.0 | 60 | 15.18" | 569.49 |



Spa Pumps / Center Discharge - 48-Frame

FEATURES:

- Reliable center discharge performance
- 1 1/2" intake and discharge
- Wet end can be rotated for easy installation
- Available in 3/4 to 2 HP, 1 or 2 speed
- Viton Seals
- One-year warranty on motor, three-year warranty on wet end

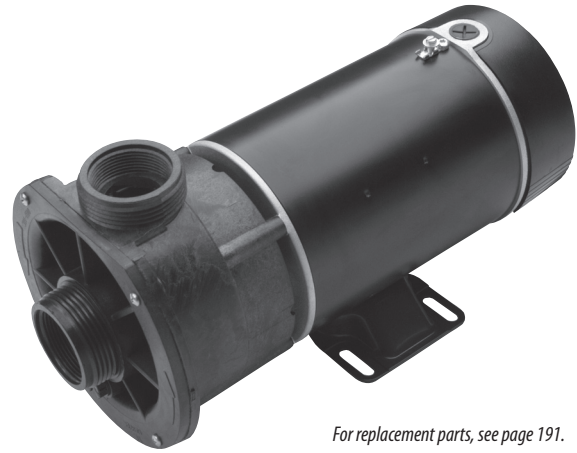

For replacement parts, see page 191.

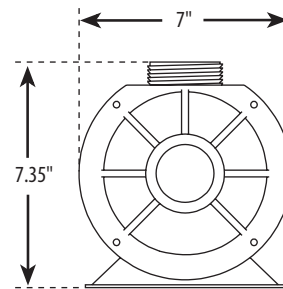

PRESSURE VERSUS FLOW RATE

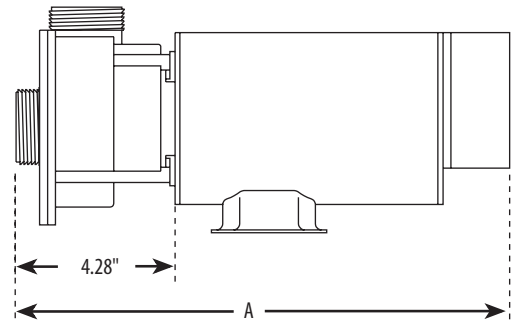
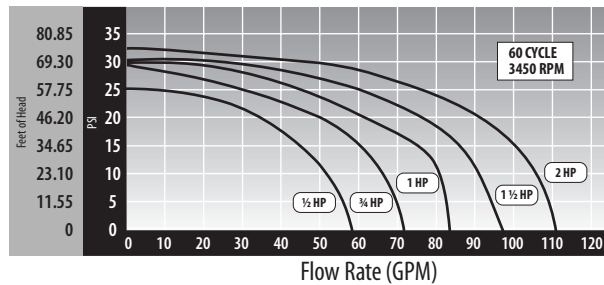

2-Speed Center Discharge Spa Pumps

| Part No. | HP | Volts | Amps High Speed | Amps Low Speed | Hz | Dimension "A" | List (US \$) |
|-------------------|-----|-------|-----------------|----------------|----|---------------|--------------|
| 3420310-15 | 3/4 | 115 | 8.8 | 2.6 | 60 | 15.00" | 434.98 |
| 3420410-15 | 1.0 | 115 | 11.0 | 2.9 | 60 | 15.00" | 455.33 |
| 3420610-15 | 1.5 | 115 | 16.4 | 4.4 | 60 | 15.75" | 497.21 |
| 3420620-15 | 1.5 | 230 | 8.0 | 2.6 | 60 | 15.73" | 497.21 |
| 3420820-15 | 2.0 | 230 | 10.5 | 2.6 | 60 | 16.28" | 526.81 |

1-Speed Center Discharge Spa Pumps

| Part No. | HP | Volts | Amps | Hz | Dimension "A" | List (US \$) |
|-------------------|-----|---------|-------|----|---------------|--------------|
| 3410310-15 | 3/4 | 115 | 9.8 | 60 | 14.00" | 376.63 |
| 3410410-15 | 1.0 | 115 | 12.0 | 60 | 14.50" | 393.96 |
| 3410610-15 | 1.5 | 115 | 17.0 | 60 | 15.05" | 423.36 |
| 3410830-15 | 2.0 | 115/230 | 20-10 | 60 | 16.26" | 484.81 |



FEATURES:

- Universal Input Volute
(Can be rotated to 12:00,3:00,6:00, or 9:00 positions)
- 24-hour circulation
- 48-Frame proven design
- Side Discharge for optimum performance
- 1/8 HP
- Low power usage (0.8/1.6 amps)
- Viton seals
- 1 1/2" Union In/Out
- One year limited warranty



PRESSURE VERSUS FLOW RATE

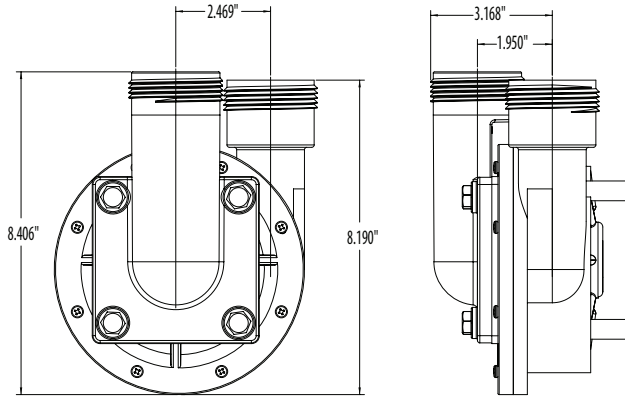
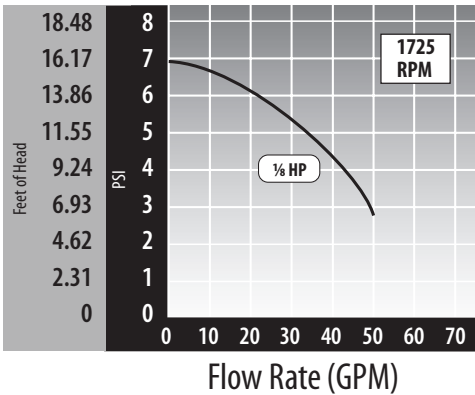

Uni-Might Pumps

| Part No. | Description | HP | Volts | Amps | Hz | List (US \$) |
|-------------------|----------------|-----|-------|------|-------|--------------|
| 3410030-0X | Uni-Might Pump | 1/8 | 115 | 1.6 | 50/60 | 299.05 |
| 3410020-0X | Uni-Might Pump | 1/8 | 230 | 0.8 | 50/60 | 299.05 |



Uni-Might Wet End

| Part No. | Description | Rating | List (US \$) |
|-----------------|-------------------|--------|--------------|
| 310-5070 | Uni-Might Wet End | 1/8 | 90.79 |



Spa Pumps / Iron Might

FEATURES:

- 24-hour circulation
- 48-frame proven design
- Side discharge for optimum flow
- Multiple union assemblies available
- Delivers 40 GPM
- 1/8 HP
- Only 1.3 Amps
- Viton seals
- 1 1/2" Intake and Discharge
- One year warranty on motor and wet end



PRESSURE VERSUS FLOW RATE

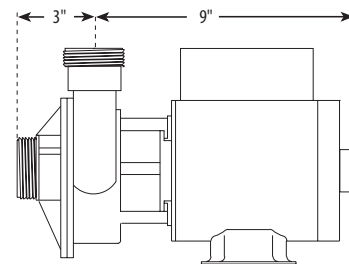
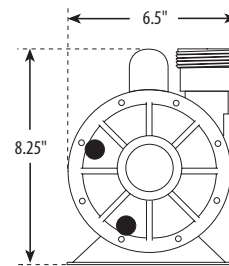
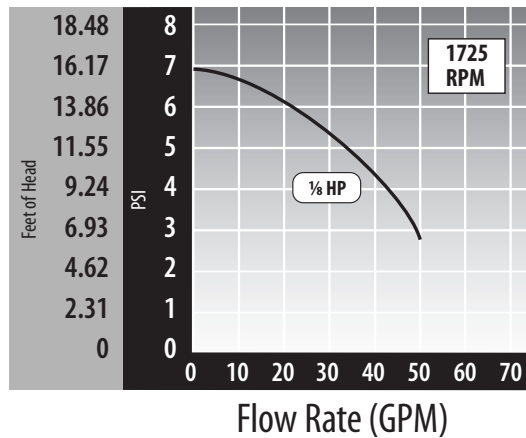

Iron Might 1-Speed 48-Frame Circulating Pumps

| Part No. | HP | Volts | Hz | Case Quantity | List (US \$) |
|-------------------|-----|-------|----|---------------|--------------|
| 3410020-1E | 1/8 | 230 | 60 | 1 | 302.14 |
| 3410030-1E | 1/8 | 115 | 60 | 1 | 302.14 |

Leaf Trap (sold separately)

| Part No. | Description | Case Quantity | List (US \$) |
|-----------------|---------------------------------------|---------------|--------------|
| 310-5400 | Leaf Trap – 1 1/2" Union x 1 1/2" FPT | 5 | 70.88 |



Pond Pump - Iron Might with Trap

| Part No. | Description | List (US \$) |
|---------------------|---------------------------------|--------------|
| 3410030-1E77 | 1/8 HP - 115V - 6 ft. NEMA Cord | 382.73 |



FEATURES:

- High volume side discharge efficiency
- 60% more efficient than our center discharge pumps
- Side discharge for optimum flow
- 1" union or 1" barb
- Wet end can be rotated for easy installation
- 1/16 HP
- Large 6 1/2" diameter wet end for higher head pressure
- One year warranty on motor, lifetime on pump

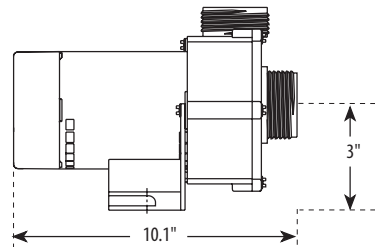
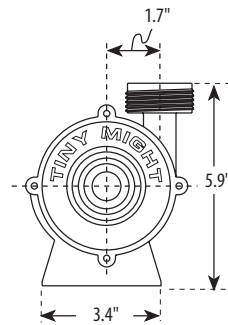

PRESSURE VERSUS FLOW RATE

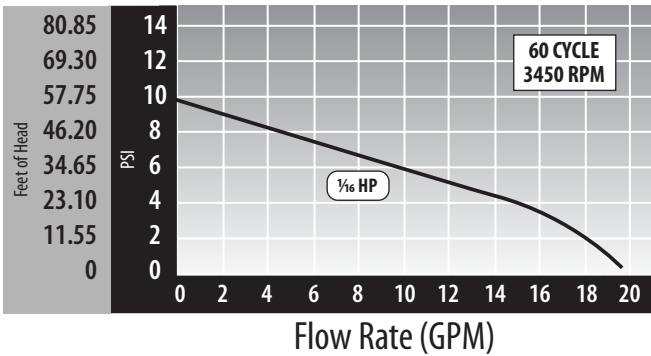

Tiny Might Circulating Pumps

| Part No. | Description | HP | Volts | Amps | Hz | List (US \$) |
|-------------------|---------------------|------|-------|------|-------|--------------|
| 3312610-14 | 1" Union x 1" Union | 1/16 | 115 | 0.8 | 60 | 281.63 |
| 3312620-14 | 1" Union x 1" Union | 1/16 | 230 | 0.4 | 50/60 | 281.63 |
| 3312610-19 | 1" Barb x 1" Barb | 1/16 | 115 | 0.8 | 60 | 281.63 |
| 3312620-19 | 1" Barb x 1" Barb | 1/16 | 230 | 0.4 | 50/60 | 281.63 |



Spa Pumps / Wet Ends



310-0140

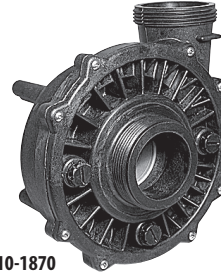

310-1870



310-1800

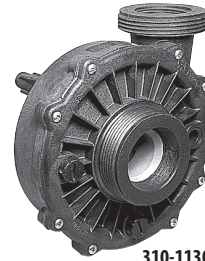

310-1130SD

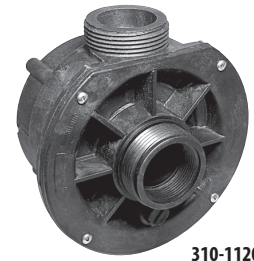

310-1120

2 1/2" Viper Wet Ends

| Part No. | Motor | Rating | Case Quantity | List (US \$) |
|-----------------|----------|--------|---------------|--------------|
| 310-0140 | 56-Frame | 4 HP | 8 | 100.34 |

2" Executive Wet Ends

| Part No. | Motor | Rating | Case Quantity | List (US \$) | Part No. | Motor | Rating | Case Quantity | List (US \$) |
|-----------------|----------|----------|---------------|--------------|-----------------|----------|--------|---------------|--------------|
| 310-1870 | 48-Frame | 1 HP | 8 | 100.34 | 310-1710 | 56-Frame | 1 HP | 8 | 100.34 |
| 310-1880 | 48-Frame | 1 1/2 HP | 8 | 100.34 | 310-1720 | 56-Frame | 2 HP | 8 | 100.34 |
| 310-1890 | 48-Frame | 2 HP | 8 | 100.34 | 310-1730 | 56-Frame | 3 HP | 8 | 100.34 |
| 310-1900 | 48-Frame | 3 HP | 8 | 100.34 | 310-1740 | 56-Frame | 4 HP | 8 | 100.34 |
| 310-1910 | 48-Frame | 4 HP | 8 | 100.34 | 310-1750 | 56-Frame | 5 HP | 8 | 100.34 |
| 310-1920 | 48-Frame | 4 1/2 HP | 8 | 100.34 | | | | | |
| 310-1930 | 48-Frame | 5 HP | 8 | 100.34 | | | | | |

2 1/2" Executive Wet Ends

| Part No. | Motor | Rating | Case Quantity | List (US \$) | Part No. | Motor | Rating | Case Quantity | List (US \$) |
|-----------------|----------|----------|---------------|--------------|-----------------|----------|--------|---------------|--------------|
| 310-1800 | 48-Frame | 1 HP | 8 | 100.34 | 310-1460 | 56-Frame | 1 HP | 8 | 100.34 |
| 310-1810 | 48-Frame | 1 1/2 HP | 8 | 100.34 | 310-1480 | 56-Frame | 2 HP | 8 | 100.34 |
| 310-1820 | 48-Frame | 2 HP | 8 | 100.34 | 310-1500 | 56-Frame | 3 HP | 8 | 100.34 |
| 310-1840 | 48-Frame | 3 HP | 8 | 100.34 | 310-1440 | 56-Frame | 4 HP | 8 | 100.34 |
| 310-1860 | 48-Frame | 4 HP | 8 | 100.34 | 310-1510 | 56-Frame | 5 HP | 8 | 100.34 |
| 310-1850 | 48-Frame | 4 1/2 HP | 8 | 100.34 | | | | | |
| 310-1830 | 48-Frame | 5 HP | 8 | 100.34 | | | | | |

2" Hi-Flo Side Discharge Wet Ends

| Part No. | Rating | Case Quantity | List (US \$) |
|-------------------|----------|---------------|--------------|
| 310-1130SD | 1 HP | 15 | 100.34 |
| 310-1140SD | 1 1/2 HP | 15 | 100.34 |
| 310-1141SD | 2 HP | 15 | 100.34 |
| 310-1150SD | 3 HP | 15 | 100.34 |
| 310-1160SD | 4 HP | 15 | 100.34 |

1 1/2" Center Discharge Wet Ends

| Part No. | Rating | Case Quantity | List (US \$) |
|-----------------|----------|---------------|--------------|
| 310-1120 | 3/4 HP | 12 | 96.48 |
| 310-1130 | 1 HP | 12 | 96.48 |
| 310-1140 | 1 1/2 HP | 12 | 96.48 |
| 310-1141 | 2 HP | 12 | 96.48 |