

SPECIFICATIONS	
SHELL WEIGHT:	1700 LBS.
WATER WEIGHT:	4483 LBS.
TOTAL SHELL & WATER WEIGHT:	6183.1 LBS.
WATER VOLUME:	91 Cu.Ft.
MAX WATER GAL:	681 GAL.
SURFACE AREA:	41.1 SQ. FT.
IAPMO#:	1138
FDA#:	2030305

CAPRI

ALL TILED SPA - Fits 4 Adults

SKID SUPPORT STRUCTURE* BONDED TO SPA

☒ ☐

*SKIDS SUPPLIED BY NESPA

LIGHT NICHE

SPA BRIGHT, 120 V, 100 WATT, 50' CORD, U.L. APPROVED



MAIN DRAIN

6" Round Hockey Puck
 Aquapro 6HPHAxxx
 Sumpless Suction Outlet
 Floor/Wall 224 GPM @ 6.3fps
 Complies w/ ANSI Code
 ASME A112.19.8-2007 & VGB 2008



SIDEWALL SUCTION

6" Round Hockey Puck
 Aquapro 6HPHAxxx
 Sumpless Suction Outlet
 Floor/Wall 224 GPM @ 6.3fps
 Complies w/ ANSI Code
 ASME A112.19.8-2007 & VGB 2008



SKIMMER

FRONT ACCESS SKIMMER, NSF APPROVED

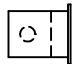

JET

HYDRO INLETS
 1-1/2" WATER - 1-1/2" AIR
 HYDROAIR #10-5100
 COMPLIES W/ ANSI CODE ASME A112.19.8-07
 UL APPROVED



RETURN

INLET FITTINGS
 1-1/2" WALL TYPE W/ EYEBALL
 HYDROAIR #10-3500
 COMPLIES W/ ANSI CODE ASME A112.19.8-07
 UL APPROVED



FILL

INLET FITTINGS
 1-1/2" WALL TYPE W/ EYEBALL
 HYDROAIR #10-3500
 COMPLIES W/ ANSI CODE ASME A112.19.8-07
 UL APPROVED

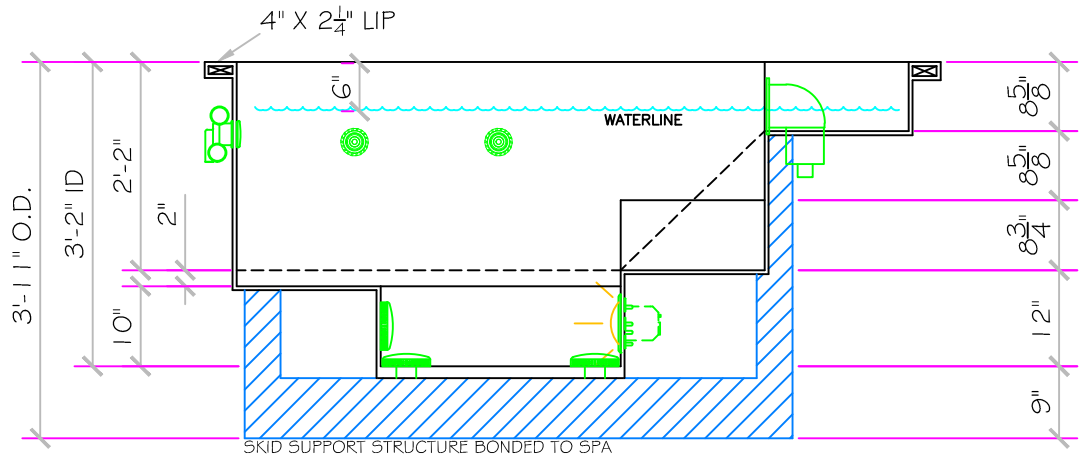
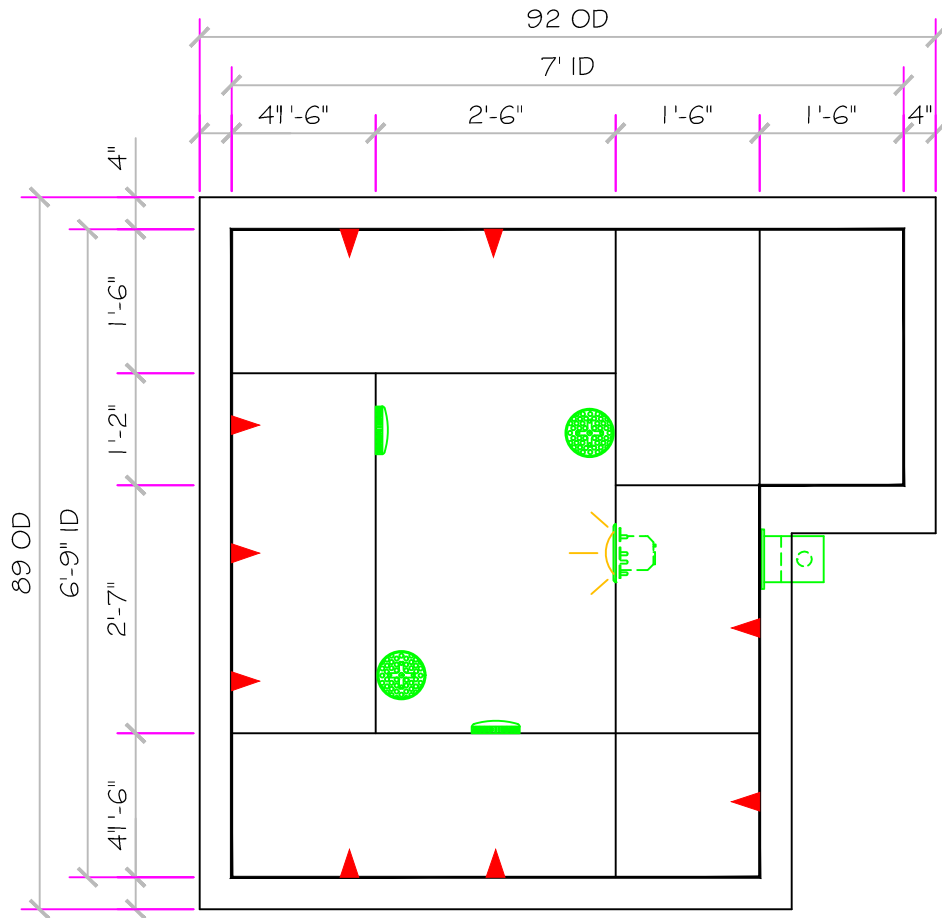



All drawing dimensions supplied by NESPA ENTERPRISES INC. are for reference only. All CAD files were created using AutoCAD file (*.dwg.) and were provided as a service to our customers using AutoCAD. Errors sometimes occur during this process and with software incompatibility upon opening a file. NESPA ENTERPRISES INC. and/or any authorized distributor of our products will not be held responsible for problems arising from files which have been converted and does not warranty the documents against deficiencies or typographical errors of any kind. We recommend that all measurements are verified with actual physical product before any custom fabrication in the field occurs.

NESPA ENTERPRISES INC.

2800 Richter Ave. Suite C Oroville, CA 95966
 Office: (530) 534-9910 Fax: (530) 534-9915
 E-Mail: jim@tiledspas.com Web Site: www.tiledspas.com

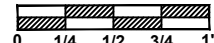
SCALE
 3/8" = 1"



DWG TYPE

SD

DWG NAME RESIDENTIAL MODELS 2012

DATE 8/12/2012

SHEET PAGE 1 OF 1